

- SIDEWALK NOTES:**
1. SIDEWALK LONGITUDINAL SLOPE NOT TO EXCEED 5%.
 2. SIDEWALK CROSS SLOPE NOT TO EXCEED 2%.
 3. PROVIDE 1/8" CONSTRUCTION JOINTS AT 5' O.C., MINIMUM DEPTH 1/2".
 4. CONCRETE TO BE 3000 p.s.i. IN 28 DAYS.
 5. CURE ALL CONCRETE WITH CLEAN SAND, PLASTIC MEMBRANE, OR OTHER APPROVED METHOD.
 6. 4" MAXIMUM SLOPE TO MEET EXISTING GRADE FROM PROPOSED SIDEWALK TYPICAL SOD RESTORATION AS REQUIRED.

LEGEND

	PROPOSED ASPHALT
	PROPOSED CONC.
	PROPOSED GRADE

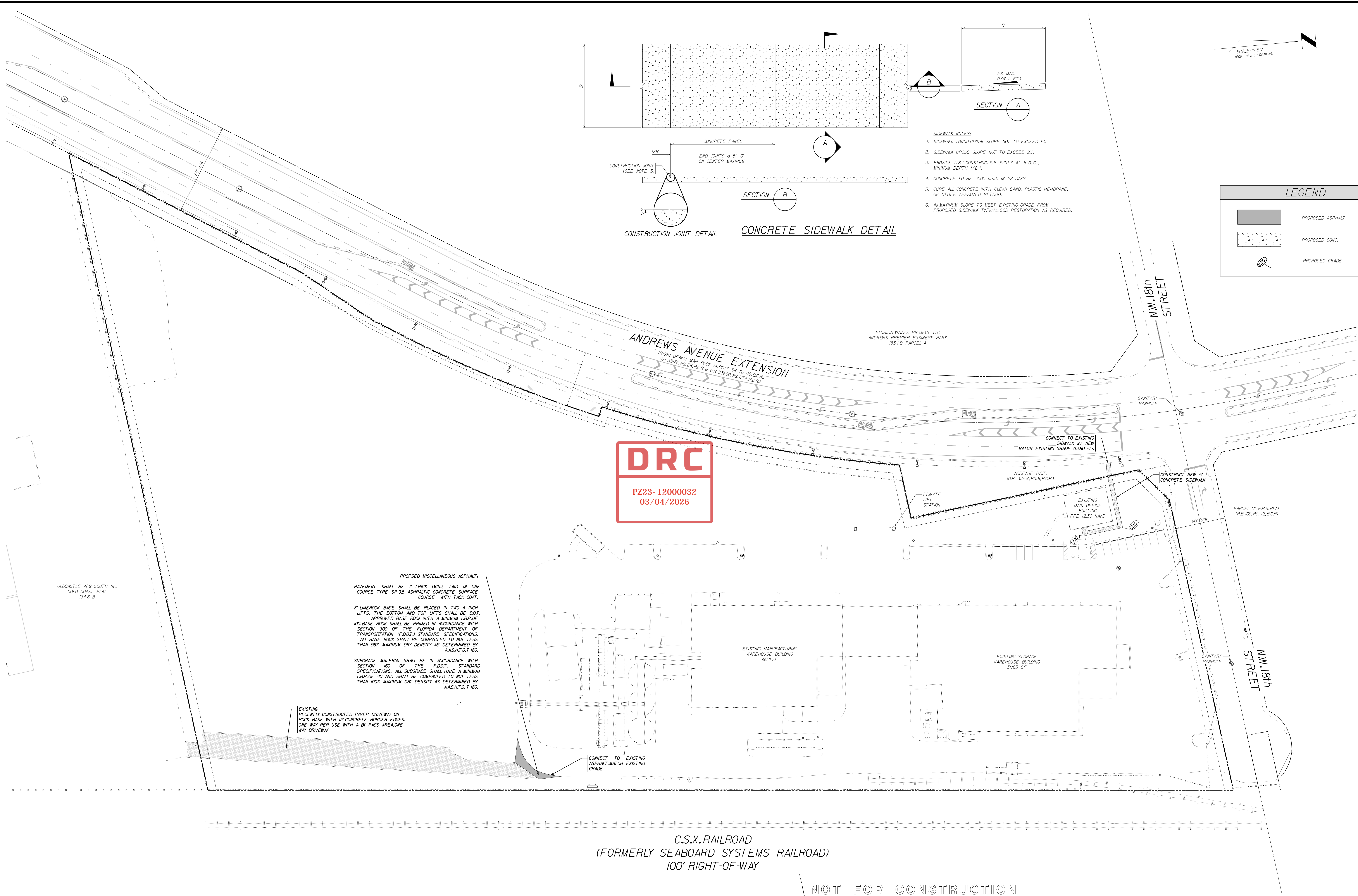

PROPOSED MISCELLANEOUS ASPHALT:
PAVEMENT SHALL BE 7" THICK MIN. LAID IN ONE COURSE TYPE SP-9.5 ASPHALTIC CONCRETE SURFACE COURSE WITH TACK COAT.
8" LIME ROCK BASE SHALL BE PLACED IN TWO 4" INCH LIFTS. THE BOTTOM AND TOP LIFTS SHALL BE DDT APPROVED BASE ROCK WITH A MINIMUM LBR OF 100. BASE ROCK SHALL BE PRIMED IN ACCORDANCE WITH SECTION 300 OF THE FLORIDA DEPARTMENT OF TRANSPORTATION (F.D.O.T.) STANDARD SPECIFICATIONS. ALL BASE ROCK SHALL BE COMPACTED TO NOT LESS THAN 98% MAXIMUM DRY DENSITY AS DETERMINED BY AASHTO T-99.
SUBGRADE MATERIAL SHALL BE IN ACCORDANCE WITH SECTION 160 OF THE F.D.O.T. STANDARD SPECIFICATIONS. ALL SUBGRADE SHALL HAVE A MINIMUM LBR OF 40 AND SHALL BE COMPACTED TO NOT LESS THAN 100% MAXIMUM DRY DENSITY AS DETERMINED BY AASHTO T-99.

EXISTING
RECENTLY CONSTRUCTED PAVED DRIVEWAY ON
ROCK BASE WITH 12" CONCRETE BORDER EDGES.
ONE WAY PER USE WITH A 5' PASS AREALONE
WAY DRIVEWAY

C.S.X. RAILROAD
(FORMERLY SEABOARD SYSTEMS RAILROAD)
100' RIGHT-OF-WAY

NOT FOR CONSTRUCTION

DESIGNED: WTV DATE: 07/2018				DRAWN: AMF DATE: 07/2018				CHECKED: W.T.V. DATE: 12/2019				PUBLISHED: 1/23/2026, 10:34:10 AM			
NO.				REVISIONS				DATE				NO.			

WINNINGHAM & FRADLEY
ENGINEERS • PLANNERS • SURVEYORS
111 N.E. 44th STREET
954.771.7440 fax: 954.771.0298 • www.winfrad.com

BONSAL AMERICAN POMPAPO
OLDCASTLE COASTAL

CONCEPTUAL ENGINEERING
PLAN

APPROVED:
DATE:
PROJECT NUMBER 18028.01

SHEET 1 OF 1